

2P,3P

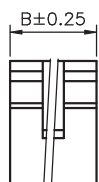

2.50±0.10
A±0.20



B±0.25

4P~6P

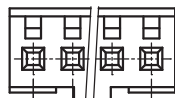

A±0.20

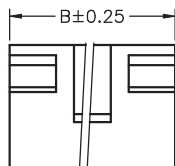

B±0.25

7P~15P

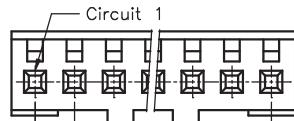

2.50±0.10
A±0.20

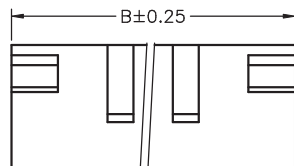

B±0.25

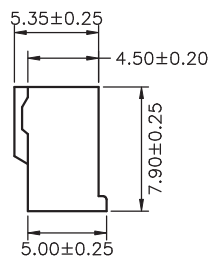
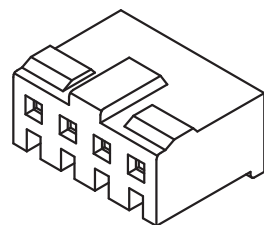

TYPE 1

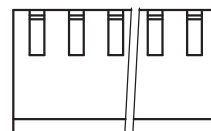

Ordering Information:

A2500H-XP - *
1 2

1.Part No.

2.Style:

1-Type 1

2-Type 2

13P~15P

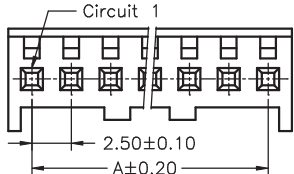

2.50±0.10
A±0.20

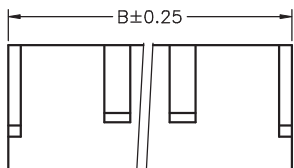

B±0.25

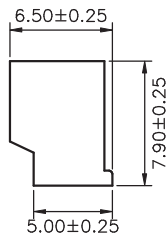

TYPE 2

SPECIFICATIONS

Current Rating: 3A AC,DC

Voltage Rating: 500V AC,DC

Temperature Range: -25°C ~ +85°C

Contact Resistance: 20mΩ Max

Insulation Resistance: 100MΩ Min

Withstanding Voltage: 1500V AC/minute

Material: Nylon 66,UL94V-0

Pantone Color: 153C

Ordering Information & Dimensions

PART NO.	Dimensions	
	A	B
A2500H-2P	2.50	5.50
A2500H-3P	5.00	8.00
A2500H-4P	7.50	10.50
A2500H-5P	10.00	13.00
A2500H-6P	12.50	15.50
A2500H-7P	15.00	18.00
A2500H-8P	17.50	20.50
A2500H-9P	20.00	23.00
A2500H-10P	22.50	25.50
A2500H-11P	25.00	28.00
A2500H-12P	27.50	30.50
A2500H-13P	30.00	33.00
A2500H-14P	32.50	35.50
A2500H-15P	35.00	38.00

广瑞电子科技有限公司				
UNIT	SCALE	SHEET	TITLE:	
mm		1 of 1	2.50mm PITCH HOUSING	
DRAWN BY	APPROVED BY	DRAW NO. :		
SUSAN	HENLY	A2500H-XP-X		
2001.02.01	2001.02.01	REV. B0		
GENERAL TOLERANCE				
X. X±0.25	ANGLE±			
X. XX±0.15				
X. XXX±0.05				
B0	NEW RELEASE	2006.02.21		
REV.	DESCRIPTION	DATE		

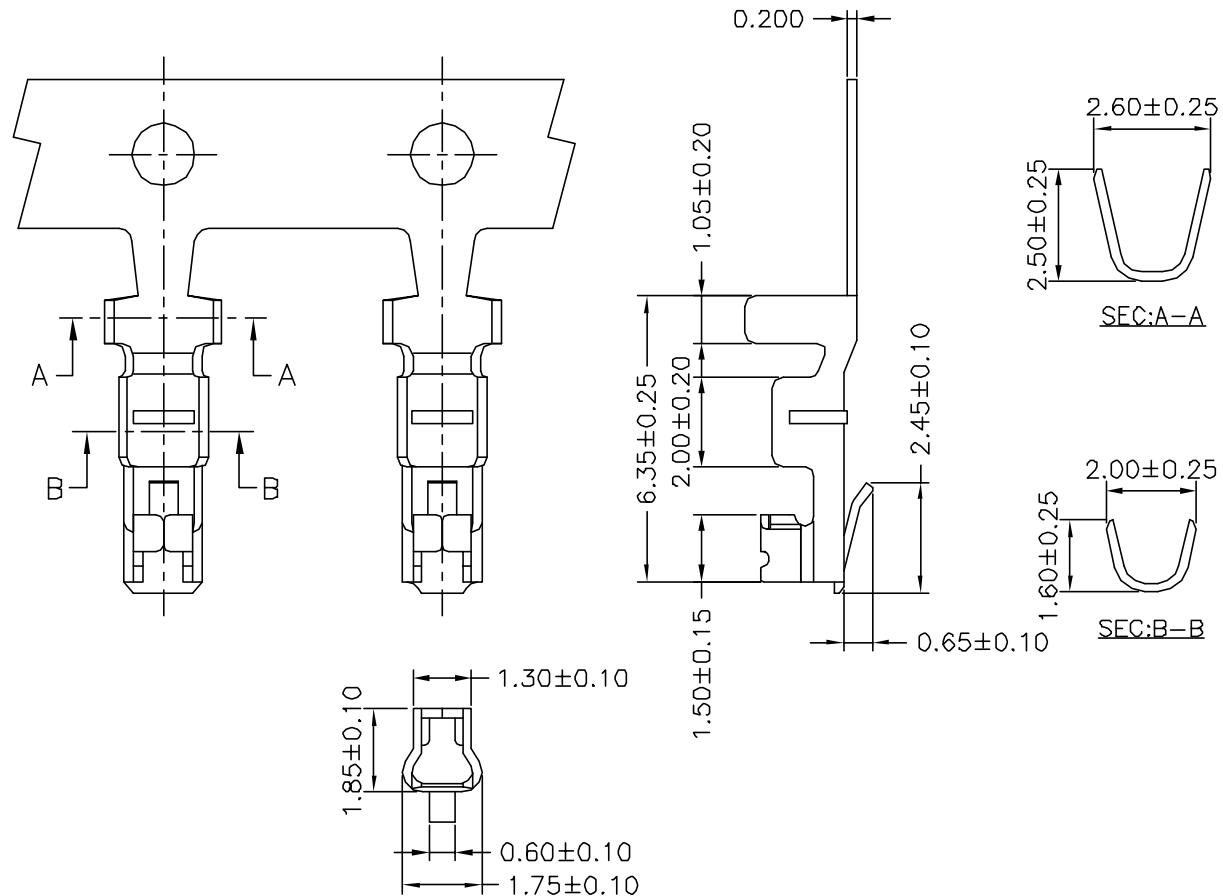

Ordering Information & Specifications

PART NO.	Wire Range	Insulation O.D.	Material	Finish	Qty/reel
A2500-TPE	AWG#22-#28	1.70mm(max)	Phosphor Bronze	Tin-plated	10,000pcs

Note:E-Stamping before Tin-plated

广瑞电子科技有限公司					
			UNIT	SCALE	SHEET
			mm		1 of 1
			DRAWN BY	APPROVED BY	TITLE :
			SUSAN	HENLY	2.50mm PITCH
			2001.02.01	2001.02.01	CRIMP TERMINAL
			GENERAL TOLERANCE		
B1	REVISE	2008.05.23	X.X ±0.25	ANGLE ±	
B0	NEW RELEASE	2006.02.21	X.XX ±0.15		
REV.	DESCRIPTION	DATE	X.XXX ±0.05		
DRAW NO. : A2500-XX					REV. B1

2P,3P

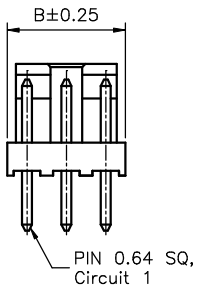
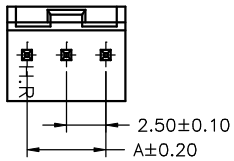

4P~6P

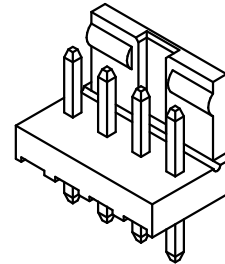
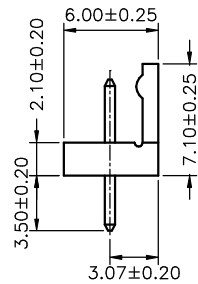
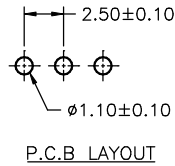
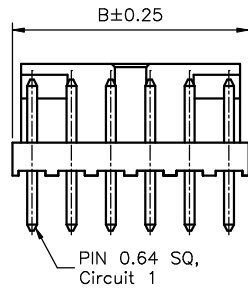
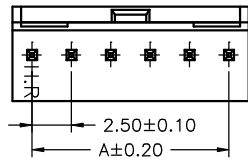

7P~15P

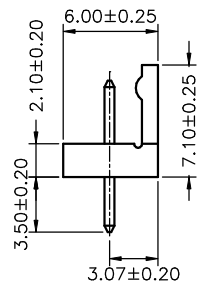
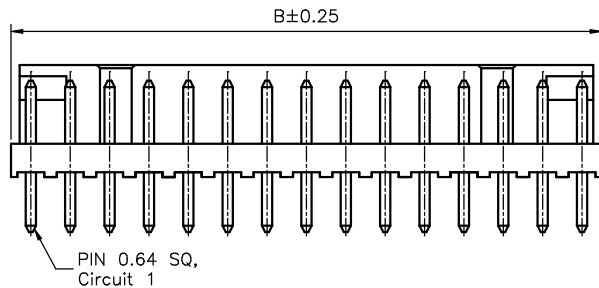
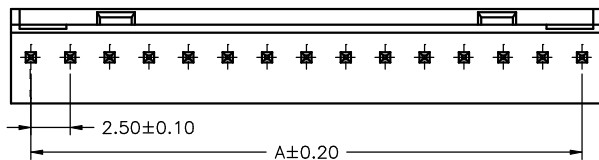

SPECIFICATIONS

Current Rating: 3A AC,DC
 Voltage Rating: 500V AC,DC
 Temperature Range: -25°C ~ +85°C
 Contact Resistance: 20mΩ Max
 Insulation Resistance: 100MΩ Min
 Withstanding Voltage: 1500V AC/minute
 Pin Material: Brass/Tin-plated
 Material: Nylon 66,UL94V-0
 Pantone Color: 153C

Ordering Information & Dimensions

PART NO.	Dimensions	
	A	B
A2500WV-2P	2.50	5.00
A2500WV-3P	5.00	7.50
A2500WV-4P	7.50	10.00
A2500WV-5P	10.00	12.50
A2500WV-6P	12.50	15.00
A2500WV-7P	15.00	17.50
A2500WV-8P	17.50	20.00
A2500WV-9P	20.00	22.50
A2500WV-10P	22.50	25.00
A2500WV-11P	25.00	27.50
A2500WV-12P	27.50	30.00
A2500WV-13P	30.00	32.50
A2500WV-14P	32.50	35.00
A2500WV-15P	35.00	37.50

广瑞电子科技有限公司

UNIT SCALE SHEET TITLE:

mm 1 of 1

DRAWN BY SUSAN 2001.02.01
 APPROVED BY HENLY 2001.02.01

GENERAL TOLERANCE

X. X±0.25 ANGLE±
 X. XX±0.15
 X. XXX±0.05

2.50mm PITCH
 180° WAFER

DRAW NO. : A2500WV-XP

REV. B0

BO	NEW RELEASE	2006.02.21
REV.	DESCRIPTION	DATE

02P,03P

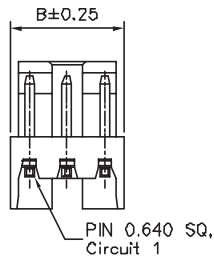
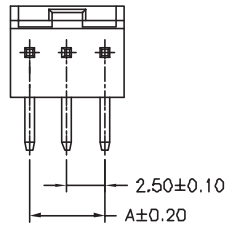

04P~06P

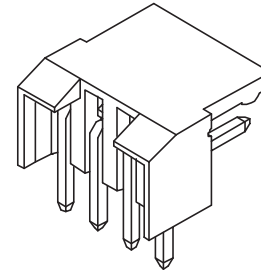
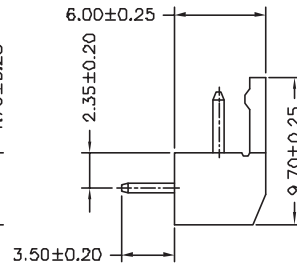
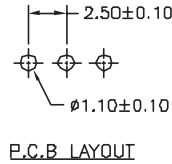
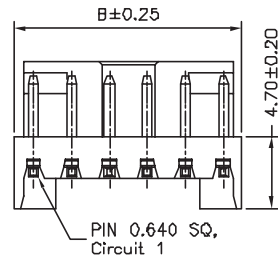
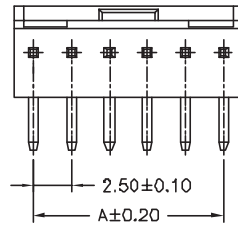

07P~15P

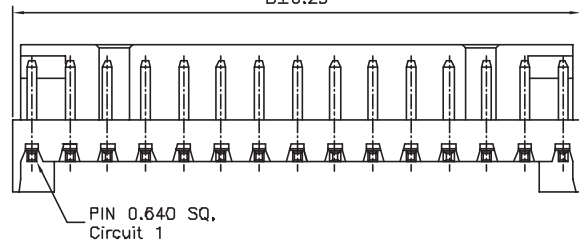
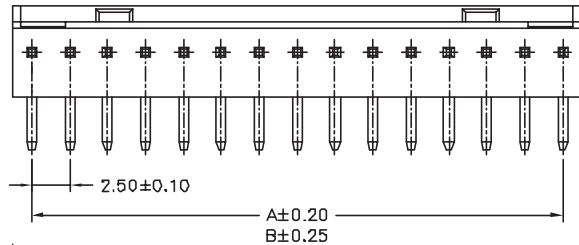

SPECIFICATIONS

Current Rating: 3A AC,DC
Voltage Rating: 500V AC,DC
Temperature Range: -25°C ~ +85°C
Contact Resistance: 20mΩ Max
Insulation Resistance: 100MΩ Min
Withstanding Voltage: 1500V AC/minute
Pin Material: Brass/Tin-plated
Material: Nylon 66,UL94V-0
Pantone Color: 153C

Ordering Information & Dimensions

PART NO.	Dimensions	
	A	B
A2500WR-02P	2.50	5.00
A2500WR-03P	5.00	7.50
A2500WR-04P	7.50	10.00
A2500WR-05P	10.00	12.50
A2500WR-06P	12.50	15.00
A2500WR-07P	15.00	17.50
A2500WR-08P	17.50	20.00
A2500WR-09P	20.00	22.50
A2500WR-10P	22.50	25.00
A2500WR-11P	25.00	27.50
A2500WR-12P	27.50	30.00
A2500WR-13P	30.00	32.50
A2500WR-14P	32.50	35.00
A2500WR-15P	35.00	37.50

广瑞电子科技有限公司

				UNIT	SCALE	SHEET	TITLE:
				mm		1 of 1	
				DRAWN BY	APPROVED BY		
				SUSAN	HENLY		
				2001.02.01	2001.02.01		
				GENERAL TOLERANCE			
B1	REVISE	2008.05.23	X.X1	0.25	ANGLE		
B0	NEW RELEASE	2006.02.21	X.XX	0.15			
REV.	DESCRIPTION	DATE	X.XXX	0.05			
						DRAW NO.:	REV.:
						A2500WR-XP	B1

2.50mm PITCH
90° WAFER