

**SPECIFICATIONS**

Current Rating: 3A AC,DC  
 Voltage Rating: 250V AC,DC  
 Temperature Range: -25°C ~ +85°C  
 Contact Resistance: 20mΩ Max  
 Insulation Resistance: 1000MΩ Min  
 Withstanding Voltage: 1000V AC/minute  
 Material: PBT,UL94V-0  
 Color: Natural(Black)

**Ordering Information & Dimensions**

PART NO.	Dimensions		
	A	B	C
A2543H-2P	2.54	7.10	5.60
A2543H-4P	7.62	12.20	10.60
A2543H-6P	12.70	17.30	15.70
A2543H-8P	17.78	22.30	20.80

<b>广瑞电子科技有限公司</b>					
UNIT	SCALE	SHEET	TITLE:		
mm		1 of 1	<b>2.54mm PITCH HOUSING</b>		
DRAWN BY	APPROVED BY				
SUSAN	HENLY				
2002.04.24	2002.04.24				
GENERAL TOLERANCE					
B1	REVISE	2005.12.20	X. X±0.25	ANGLE±	
B0	NEW RELEASE	2005.12.10	X. XX±0.15		
REV.	DESCRIPTION	DATE	X. XXX±0.05		
			DRAW NO. :	REV.	
			A2543H-XP	B1	

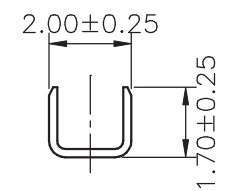
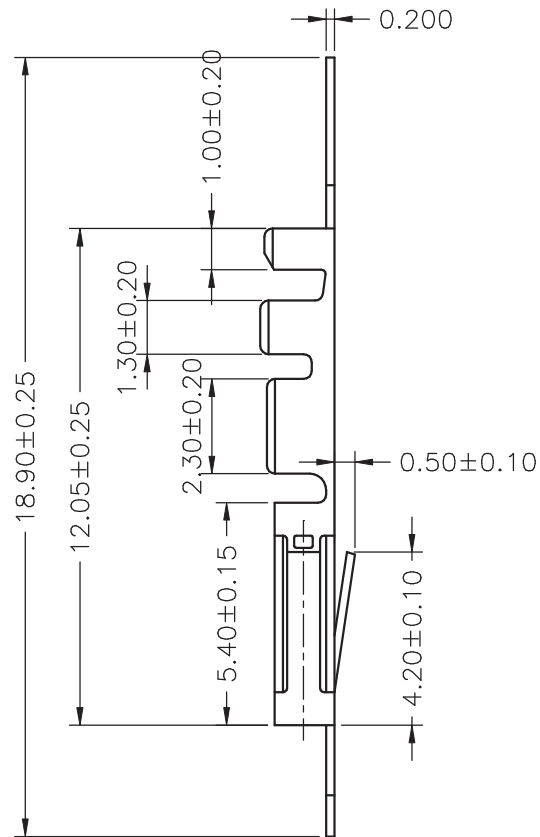
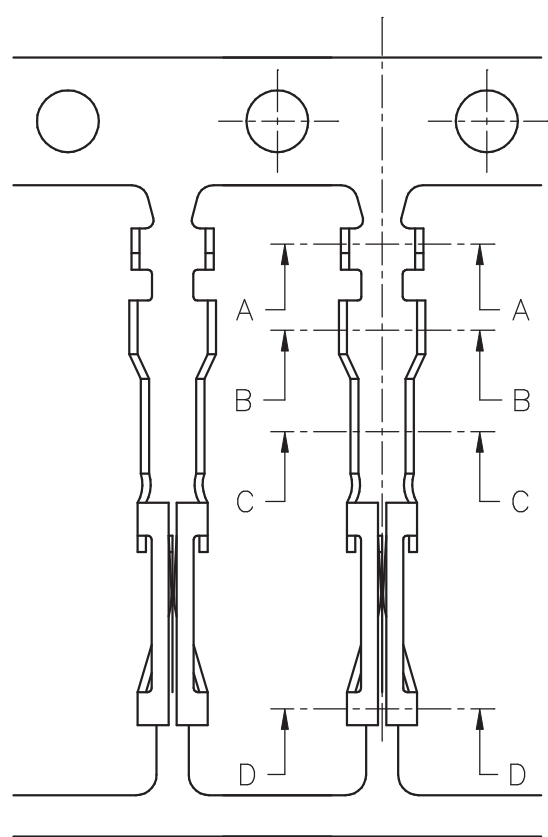

SEC:A-A

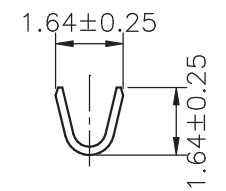

SEC:C-C

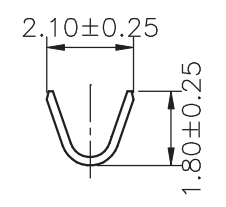

SEC:B-B

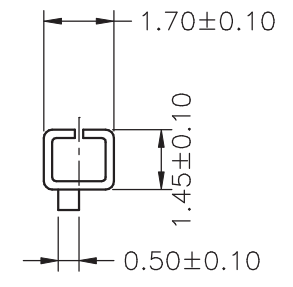

SEC:D-D

Ordering Information & Specifications

Part No	Wire Range	Insulation O.D.	Material	Finish	Qty/reel
A2543-TP	AWG#22-#26	1.55mm(max)	Phosphor Bronze	Tin-plated	20,000pcs

广瑞电子科技有限公司					
			UNIT	SCALE	SHEET
			mm		1 of 1
			DRAWN BY SUSAN		APPROVED BY HENLY
			2002. 04. 24		2002. 04. 24
			GENERAL TOLERANCE		
			X. X±0. 25	ANGLE±	
B0	NEW RELEASE	2005. 12. 10	X. XX±0. 15		
REV.	DESCRIPTION	DATE	X. XXX±0. 05		
DRAW NO. :					REV.
A2543-XX					B0

TITLE:  
**2.54mm PITCH  
CRIMP TERMINAL**

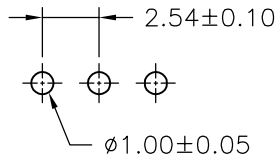
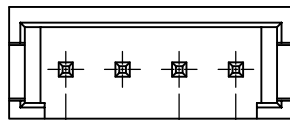
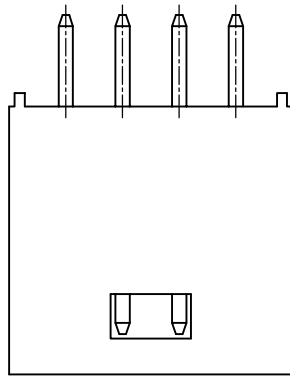

P.C.B. LAYOUT

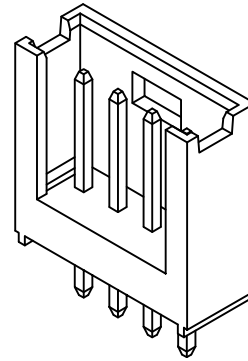
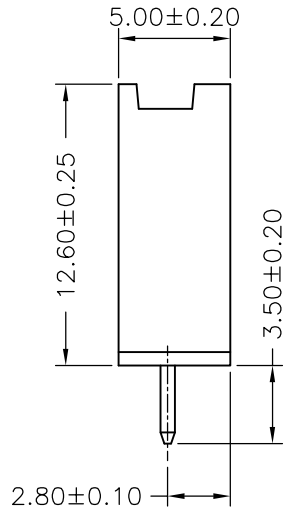
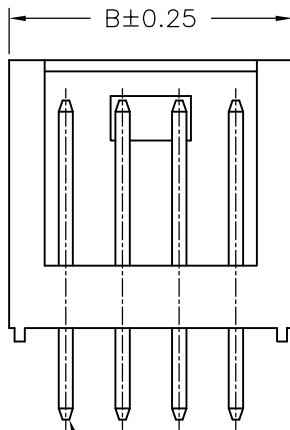
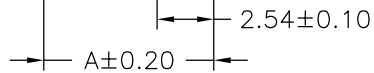

SPECIFICATIONS

Current Rating: 3A AC,DC  
 Voltage Rating: 250V AC,DC  
 Temperature Range: -25°C ~ +85°C  
 Contact Resistance: 20mΩ Max  
 Insulation Resistance: 1000MΩ Min  
 Withstanding Voltage: 1000V AC/minute  
 Pin Material: Brass/Tin-plated  
 Material: PBT,UL94V-0  
 Color: Natural(Black)

Ordering Information & Dimensions

PART NO.	Dimensions	
	A	B
A2543WV-02P	2.54	7.62
A2543WV-04P	7.62	12.70
A2543WV-06P	12.70	17.78
A2543WV-08P	17.78	22.86
A2543WV-10P	22.86	27.94

<b>广瑞电子科技有限公司</b>						
			UNIT	SCALE	SHEET	TITLE:
			mm		1 of 1	
			DRAWN BY	APPROVED BY		2.54mm PITCH 180° WAFER
			Susan	Henley		
B4	REVISE	2008.09.26	2002.04.24	2002.04.24		
B3	REVISE	2008.09.11	GENERAL TOLERANCE			
B2	REVISE	2008.01.11				
B1	REVISE	2005.12.20	X. X±0.25	ANGLE±		
B0	NEW RELEASE	2005.12.10	X. XX±0.15			
REV.	DESCRIPTION	DATE	X. XXX±0.05			DRAW NO. : A2543WV-XP
						REV. B4

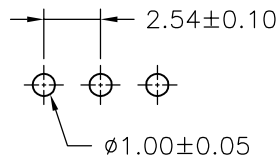
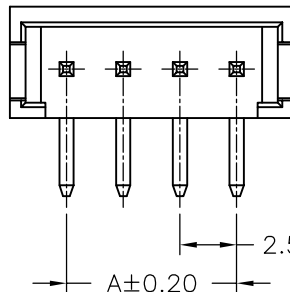
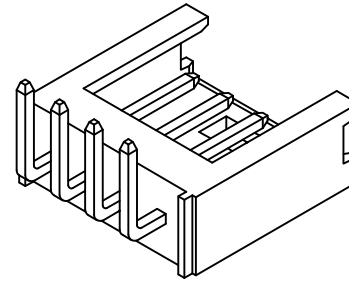
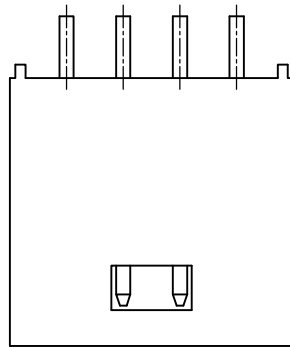

P.C.B. LAYOUT

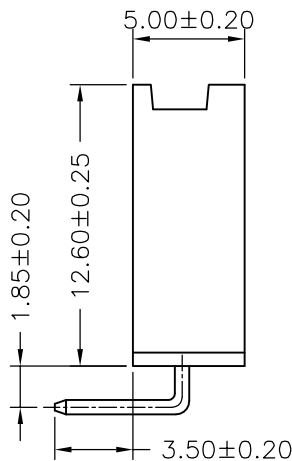
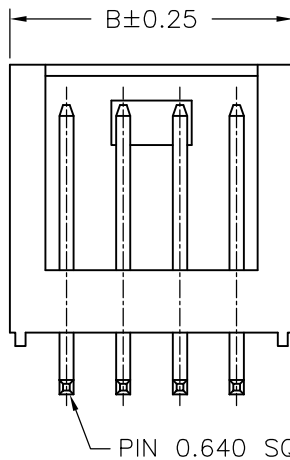

**SPECIFICATIONS**

Current Rating: 3A AC,DC  
 Voltage Rating: 250V AC,DC  
 Temperature Range: -25°C ~ +85°C  
 Contact Resistance: 20mΩ Max  
 Insulation Resistance: 1000MΩ Min  
 Withstanding Voltage: 1000V AC/minute  
 Pin Material: Brass/Tin-plated  
 Material: PBT,UL94V-0  
 Color: Natural(Black)

**Ordering Information & Dimensions**

PART NO.	Dimensions	
	A	B
A2543WR-02P	2.54	7.62
A2543WR-04P	7.62	12.70
A2543WR-06P	12.70	17.78
A2543WR-08P	17.78	22.86
A2543WR-10P	22.86	27.94

<b>广瑞电子科技有限公司</b>					
		UNIT	SCALE	SHEET	TITLE:
		mm		1 of 1	
B4	REVISE	2008.09.26	DRAWN BY Susan	APPROVED BY Henley	2.54mm PITCH 90° WAFER
B3	REVISE	2008.09.11	2002.04.24	2002.04.24	
B2	REVISE	2008.01.11	GENERAL TOLERANCE		
B1	REVISE	2005.12.20	X. X±0.25	ANGLE±	
B0	NEW RELEASE	2005.12.10	X. XX±0.15	▷ ⊕	
REV.	DESCRIPTION	DATE	X. XXX±0.05		DRAW NO. : A2543WR-XP
					REV. B4